

STATUS FLOW® SERIES

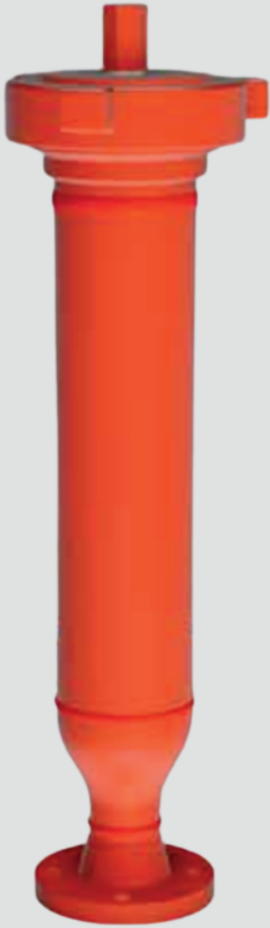

YOUR COST-EFFECTIVE SOLUTION

Performance Pulsation Control helps customers looking for a lightweight, cost-effective option thanks to the range of equipment in the Status Flow series.

FEATURES:

- Top-Repairable & Serviceable
- Compact & Lightweight
- 35 – 1200 Cubic Inch
- Up to 5,000 psi
- Threaded & Flanged Connections
- Maintenance Free ECT Option Available
- Electroless Nickel Coating (optional)
- External Safety Orange Powder Coat
- Carbon Steel with Internal Corvel® Coating
- NBR, HNBR, EPDM, & XRE Elastomers
- Optional TFE Sleeved Cartridges

BENEFITS:

- Easy Access to Maintenance
- Easy Instal
- Excellent Range of Volumes, Pressures, and Connection
- Wide Elastomer Range
- Convertible to "Maintenance Free"
- Cost Effective Corrosion Control
- High Visibility

APPLICATIONS:

- Positive Displacement Pump Suction Stabilizers & Discharge Dampeners
- O&G Mid Stream Production (Crude Oil, Amine, TEG, etc.)
- Salt Water Disposal (SWD)

CONTACT

Phone 972.699.8600

Address 3309 Essex Dr #200
Richardson, TX 75082

performancepulsation.com
sales@performancepulsation.com

Scan to view our website



FPC PERFORMANCE®
PULSATION CONTROL

BILL OF MATERIALS

FOR EASY REFERENCE

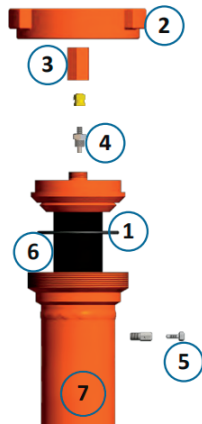

SFU SERIES	
1	SFU GASKET
2	SFU WING NUT
3	DUST CAP
4	LOADING VALVE
5	BLEEDER VALVE
6	CARTRIDGE
7	CASE

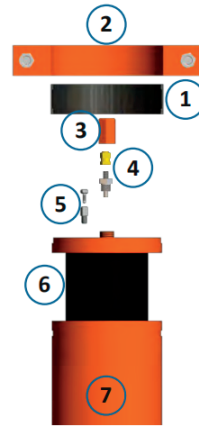

MINI, SFV & SFVM SERIES	
1	4", 6", OR 8" SUCTION GASKET
2	4", 6", OR 8" GROOVED COUPLING
3	DUST CAP
4	LOADING VALVE
5	BLEEDER VALVE
6	CARTRIDGE
7	CASE



SFT SERIES	
1	HPG-1 GASKET (NITRILE, HNBR, XRE OR EPDM)
3	DUST CAP
4	LOADING VALVE
5	BLEEDER VALVE
6	CARTRIDGE
7	CASE

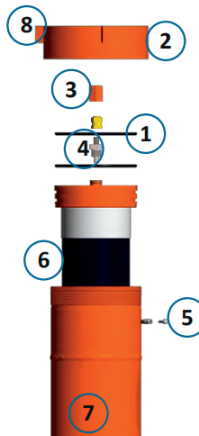

SFM SERIES	
1	SFM GASKET (2 REQUIRED)
2	SFM WING NUT
3	DUST CAP
4	LOADING VALVE
5	BLEEDER VALVE
6	CARTRIDGE
7	CASE
8	SFM WINGNUT SCREW

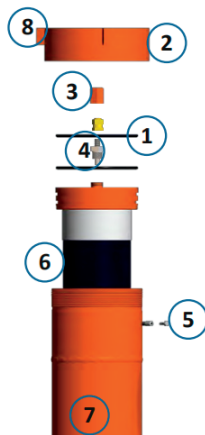

SFUM SERIES	
1	SFU GASKET
2	SFU WING NUT
3	DUST CAP
4	LOADING VALVE
5	BLEEDER VALVE
6	CARTRIDGE
7	CASE

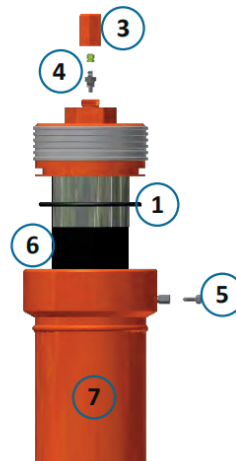

SFAT SERIES	
1	SFAT GASKET
3	DUST CAP
4	LOADING VALVE
5	BLEEDER VALVE
6	CARTRIDGE
7	CASE

